

Instructions For Use

S4[™] Safety Carton Cutter



Now personalize your cutter using the **User ID box** on back of cutter

Spare blade **Compartment** access

Blade-less tape splitter: cuts tape without exposed blade. Use with retracted (closed) blade only.

2 tray cut positions

Spare blade **Compartment**

Blade exposure **safety window**

Blade release lever releases the blade carriage button for changing blades

Top cut (Box)

Ergonomic design for small and large hands

UKH-423 Safety Holster
CL-36 -Coiled Lanyard Available



Blade Change

Using the S4[™] single-notch blade (SPO-17)



Press blade release lever and push blade carriage button forward.



Lift blade off alignment tab. Reload using alignment tab to position blade.

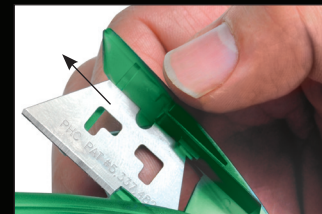

To Remove blades from blade storage compartment press from behind with index finger and slide blades forward and out with thumb.

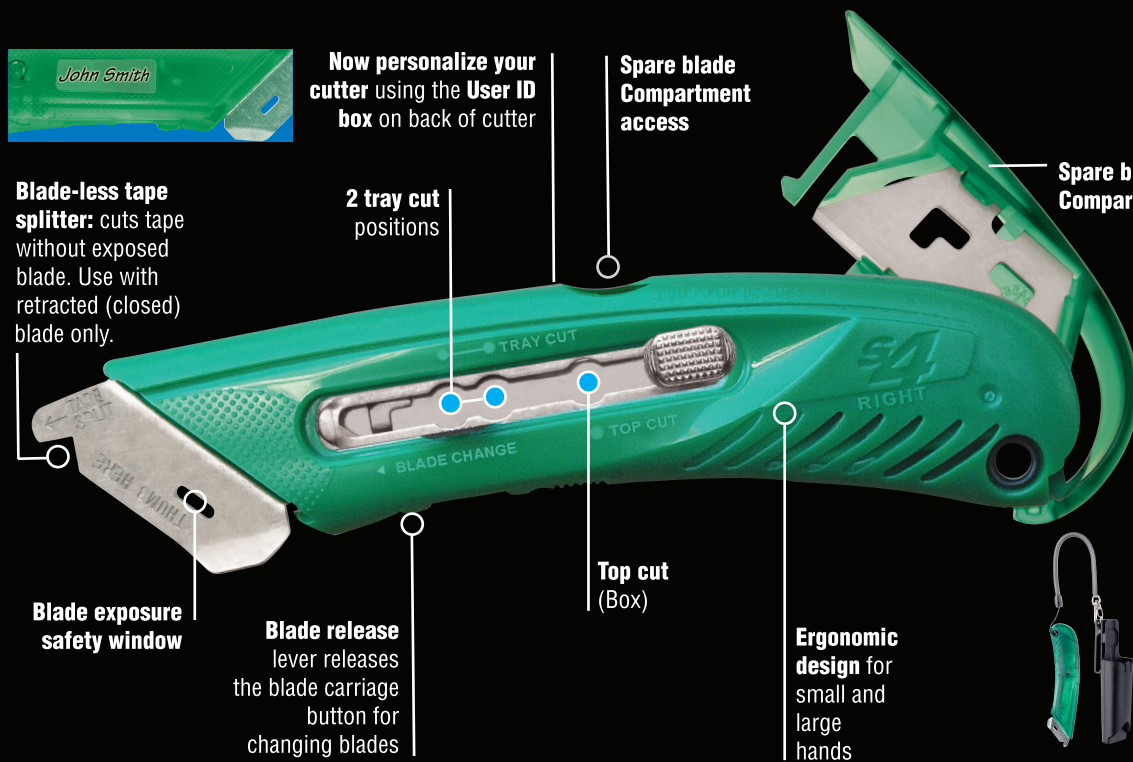

Features & Functions



Tape Cut



Top Cut



Tray Cut / Window Cut



S4L- Left-handed Safety Cutter



S4R- Right-handed Safety Cutter

For Information Call: (800) 229-2233

Email: info@go-phc.com

www.go-phc.com/s4



PHC
PACIFIC HANDY CUTTER[®]

Working Safe Everyday.™